

**8" HYDROCYCLONE STANDARD VICTAULIC MODEL**

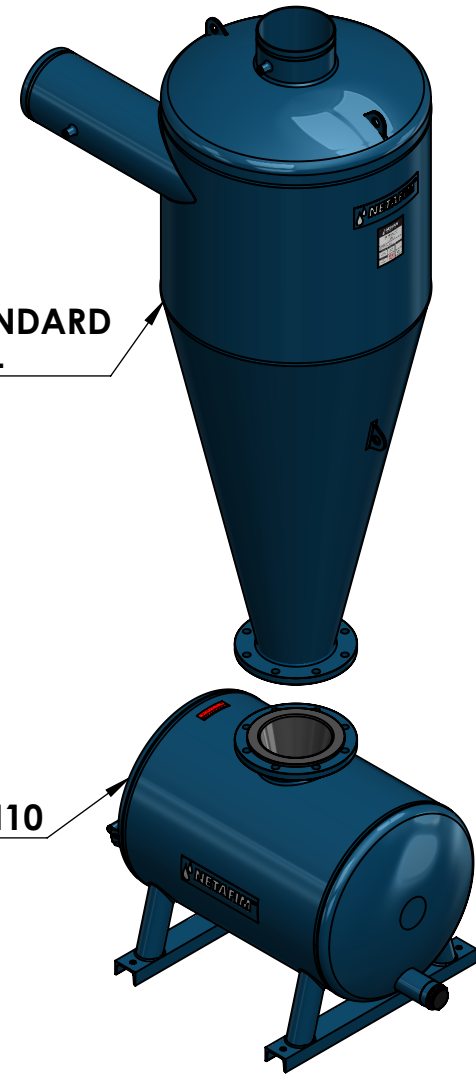

**240L DRAIN TANK 8"-ISO PN10**

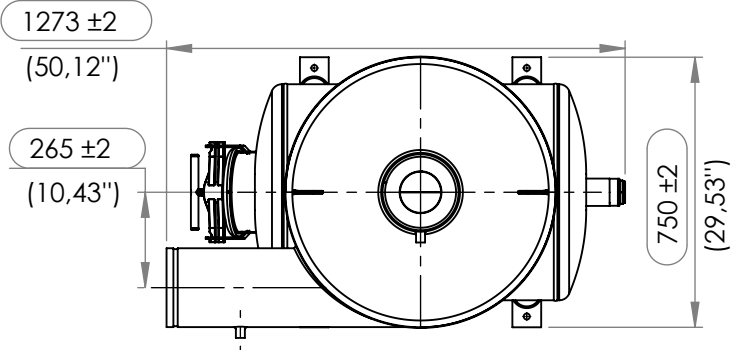

Min Flow Rate: 205m <sup>3</sup> /h (903 GPM)		Project: Filtration																											
Max Flow Rate: 400m <sup>3</sup> /h (1761 GPM)		Subject: HYDROCYCLONES																											
Pressure: 10bar (145 PSI)		SAP Code / Item Description: <b>71990-000340 / NET. HYDROCYCLONE 8" VIC+TANK 240L NPT</b>																											
Sheet Size: A4	Scale: 1:10	<b>General Tolerance According to ISO 2768-</b> <b>LINEAR DIMENSIONS</b> Permissible deviations in mm for ranges in nominal lengths <table border="1"> <tr> <td>≥ 0.5</td><td>&gt; 3</td><td>&gt; 6</td><td>&gt; 30</td><td>&gt; 120</td><td>&gt; 400</td><td>&gt; 1000</td><td>&gt; 2000</td> </tr> <tr> <td>≤ 3</td><td>≤ 6</td><td>≤ 30</td><td>≤ 120</td><td>≤ 400</td><td>≤ 1000</td><td>≤ 2000</td><td>≤ 4000</td> </tr> </table> <b>ANGULAR DIMENSIONS</b> Permissible deviations in degrees and minutes for ranges in nominal lengths <table border="1"> <tr> <td>≤ 10</td><td>&gt; 10</td><td>&gt; 50</td><td>&gt; 120</td><td>&gt; 400</td> </tr> <tr> <td>≤ 50</td><td>≤ 120</td><td>≤ 400</td><td></td><td></td> </tr> </table>		≥ 0.5	> 3	> 6	> 30	> 120	> 400	> 1000	> 2000	≤ 3	≤ 6	≤ 30	≤ 120	≤ 400	≤ 1000	≤ 2000	≤ 4000	≤ 10	> 10	> 50	> 120	> 400	≤ 50	≤ 120	≤ 400		
≥ 0.5	> 3			> 6	> 30	> 120	> 400	> 1000	> 2000																				
≤ 3	≤ 6	≤ 30	≤ 120	≤ 400	≤ 1000	≤ 2000	≤ 4000																						
≤ 10	> 10	> 50	> 120	> 400																									
≤ 50	≤ 120	≤ 400																											
3-D Proj. 																													

**NETAFIM™**

**PROPRIETARY AND CONFIDENTIAL**  
 THE INFORMATION CONTAINED IN THIS DRAWING IS THE SOLE PROPERTY OF NETAFIM. ANY REPRODUCTION IN PART OR AS A WHOLE WITHOUT THE WRITTEN PERMISSION OF NETAFIM IS PROHIBITED.

Designed By	KEREM K.	06.09.2022
Checked By	KEREM K.	06.09.2022

Sheet: 2 Of: 7 Rev. B